

WATERFALL WALL BATH/BASIN OUTLET

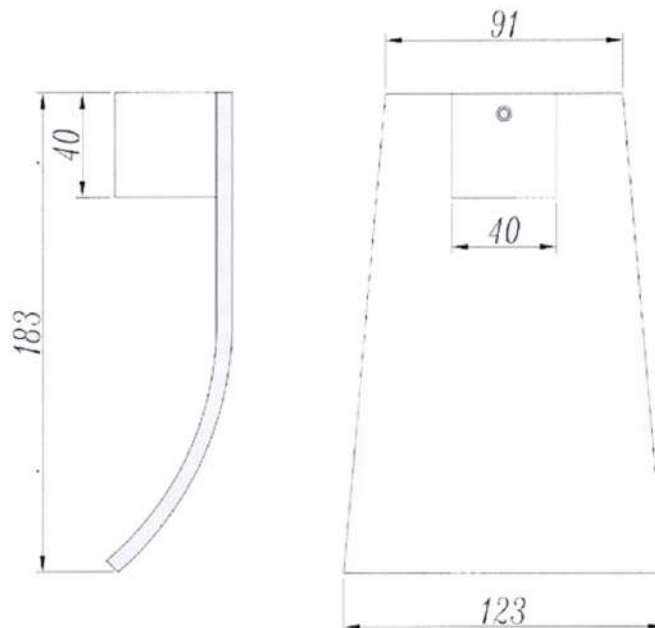

SPECIFICATIONS

Recommended use	Domestic, hotel and commercial
Colour availability	5 colors
Pressure rating	Maximum continuous operating pressure 500kPa Note: For best performance and longer life we recommend 150-500kPa
Temperature rating	Maximum continuous working temperature 75°, Min 5°C
Suitable Hot Water	Storage tank: No
Units	Continuous flow: Refer to manufacturer of continuous hot water systems Gravity Feed: Not recommended
Standards	AS/NZS 3718

CLEANING RECOMMENDATIONS

This product should not be cleaned with abrasive materials. Damage caused by any improper treatment is not covered by the product warranty - refer to Warranty Conditions on the last page.

Disclaimer: Products in this specification manual must by regulation be installed by licensed and registered trade people. The manufacturer/distributor reserves the right to vary specifications or delete models from their range without prior notification. Dimensions are nominal measurements only. Dimensions and set-outs listed are correct at time of publication however the manufacturer/distributor takes no responsibility for printing errors.

WATERFALL WALL BATH/BASIN OUTLET

INSTALLATION INSTRUCTIONS

Important Note:

Water outlet must be installed to the requirements of AS/NZS 3500 by a qualified plumber. Your water outlet comes to you already factory assembled and tested. We do not recommend the dismantling of any internal part of the water outlet. The water outlet are factory tested and sealed so as to give the best performance.

WATER SUPPLY REQUIRMENTS

Note:

1. If the pressure exceeds or likely to exceed 500kPa, an approved pressure limiting device must be installed.
2. Flush out all pipe work prior to installation.
3. If the water temperature exceeds 75°C, an approved tempering valve must be fitted.
4. Installation should comply with Australian standard AS3500.1 or relevant local authority requirements
Failure to comply with the above may void all warranties.

Maintenance and Care

Chrome plated surfaces should be cleaned with mild liquid detergent or soap and water.

Do not use cream cleaners or citrus based cleaning products, as they are abrasive.

Use of unsuitable cleaning agents may damage the surface. Any damage caused in this way will not be covered by warranty.

Installation Procedure

EXPLODED VIEW

Item Description

1. Water Outlet
2. Sealing Washer
3. Fixed base
4. Grub Screw
5. O-Ring
6. Wall Outlet

